

# Technical data sheet

## Product features



### Pot and pan washer double skin with drain pump 70x70 - 400 V

<b>Model</b>	<b>SAP Code</b>	00011973
--------------	-----------------	----------



- Display type: LCD multifunction display
- Number of programs: 11
- Number of skin: 2
- Door clear height [mm]: 850
- Rack size [mm]: 700 x 700
- Water consumption of the washing cycle [l/basket]: 4
- Detergent and rinse pump system: ProDose - accurate dosing with a peristaltic pump
- Wash pump type: two-way - DuoFlow
- Self-cleaning cycle: Yes
- Drain filter: Evolution3 - double filtration with electronically controlled partial discharge before the rinsing phase ensures 0% loss of clean water to waste

<b>SAP Code</b>	00011973	<b>Boiler capacity [ l ]</b>	12.00
<b>Net Width [mm]</b>	857	<b>Boiler power [kW]</b>	8.000
<b>Net Depth [mm]</b>	853	<b>Basin volume [l]</b>	68
<b>Net Height [mm]</b>	1959	<b>Tank power [kW]</b>	8.000
<b>Net Weight [kg]</b>	181.00	<b>Water consumption of the washing cycle [l/basket]</b>	4
<b>Power electric [kW]</b>	18.700	<b>Door clear height [mm]</b>	850
<b>Loading</b>	400 V / 3N - 50 Hz	<b>Rack size [mm]</b>	700 x 700

# Technical data sheet

Technical drawing



Pot and pan washer double skin with drain pump 70x70 - 400 V

Model

SAP Code

00011973

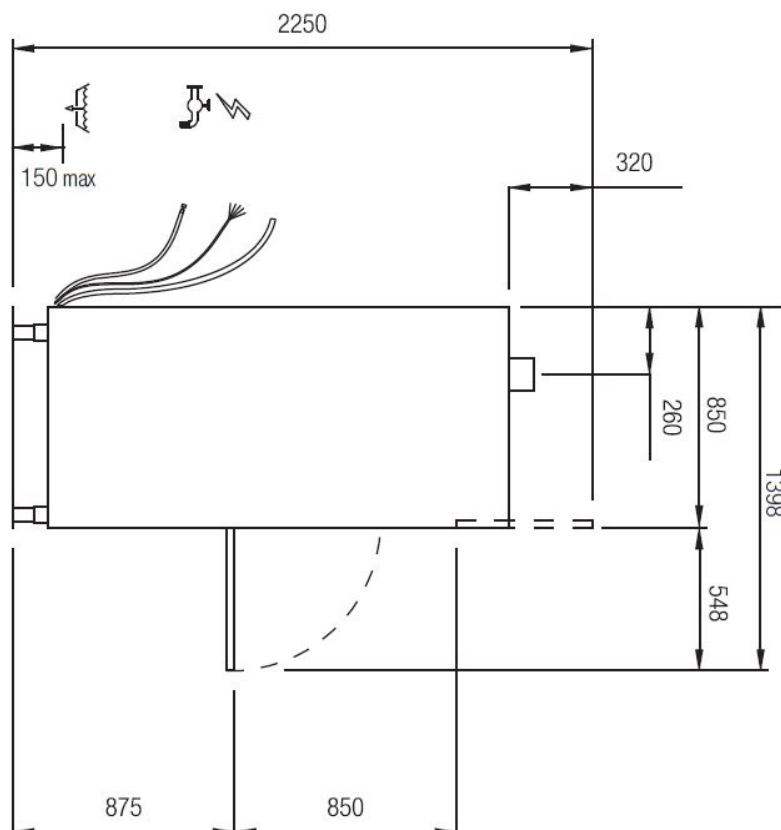
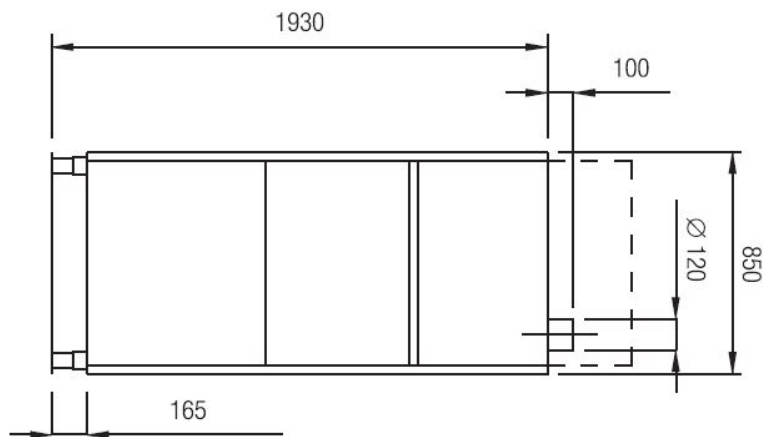

# Technical data sheet

## Product benefits



### Pot and pan washer double skin with drain pump 70x70 - 400 V

Model	SAP Code	00011973
-------	----------	----------

- 1 Stainless steel outer shell construction**  
round construction with stainless steel, rounded edges, Deep-drawn bathtub
  - easy cleaning, high hygiene standard, long service life
- 2 Stainless steel washing arms**  
upper and lower arms with stainless steel, separated for washing and rinsing, triple upper arm
  - easy and safe handling during cleaning; higher user comfort
- 3 LED Display**  
smartScreen, a large color graphic display showing the washing progress
  - easy control of the dishwasher operation
  - continuous information on the status of the wash cycle
  - diagnostics in the event of a fault
- 4 Double pump**  
unique two-way DuoFlow pump
  - distributes the water pressure evenly between the upper and lower arms; no noise; allows the use of a weaker pump
- 5 Detergent dispensers**  
two detergent and rinse aid dispensers
  - precise chemical dosing by ProDose - precise dosing system for detergent and rinse aid by peristaltic pump setting of values via control panel
- 6 Double filter system**  
the chamber filter and the waste filter together with the ArchiMedes system provide a discharge system with increased water purification efficiency
  - higher washing efficiency; longer life of the washing bath
- 7 Energy saving**  
energy saving energy saving system due to lowering the temperature of the boiler
  - cost saving
- 8 Protection of fragile dishes**  
softstart system for gradual start of washing programs to protect fragile dishes
  - protects stemmed glasses and other fragile utensils
- 9 Double shell construction**  
stainless steel construction with insulated double jacket
  - quiet operation
  - energy saving
- 10 Fast heating**  
performance management allows the current running of the boiler and basins body
  - quick first warm-up of the dishwasher
  - smooth operation
- 11 Air break tank**  
the open system of the boiler rinse, in cooperation with the rinse pump, ensures a constant pressure and temperature of the rinse
  - possibility to use in HACCP systems water temperature suitable for sterilization

# Technical data sheet

Technical parameters



## Pot and pan washer double skin with drain pump 70x70 - 400 V

Model	SAP Code	00011973
-------	----------	----------

**1. SAP Code:**

00011973

**2. Net Width [mm]:**

857

**3. Net Depth [mm]:**

853

**4. Net Height [mm]:**

1959

**5. Net Weight [kg]:**

181.00

**6. Gross Width [mm]:**

100

**7. Gross depth [mm]:**

950

**8. Gross Height [mm]:**

2200

**9. Gross Weight [kg]:**

191.00

**10. Device type:**

Electric unit

**11. Control type:**

Digital

**12. Material:**

AISI 304

**13. Power electric [kW]:**

18.700

**14. Loading:**

400 V / 3N - 50 Hz

**15. Number of programs:**

11

**16. Opening of device:**

Tilting down

**17. Door clear height [mm]:**

850

**18. Inlet pressure [bar]:**

1-6

**19. Adjustable feet:**

Yes

**20. Number of skin:**

2

**21. Self-cleaning cycle:**

Yes

**22. Boiler capacity [ l ]:**

12.00

**23. Boiler power [kW]:**

8.000

**24. Basin volume [l]:**

68

**25. Tank power [kW]:**

8.000

**26. Number of arms for both rinsing and washing:**

2

**27. Arm connection:**

Hand loosen/tighten screw

**28. Washing arm type:**

Rotating trident

# Technical data sheet

## Technical parameters



### Pot and pan washer double skin with drain pump 70x70 - 400 V

<b>Model</b>	<b>SAP Code</b>	00011973
--------------	-----------------	----------

**29. Washing arm material:**

Stainless steel

**30. Atmospheric boiler with rinse pump:**

Yes

**31. Rinsing arm type:**

Rotating trident

**32. Rinsing arm material:**

Stainless steel

**33. Deep drawn tank:**

Yes

**34. Rack support:**

Pressed

**35. Tank surface strainers:**

stainless steel

**36. Drain filter:**

Evolution3 - double filtration with electronically controlled partial discharge before the rinsing phase ensures 0% loss of clean water to waste

**37. Thermostop:**

Yes

**38. Boiler thermostat adjust:**

Yes

**39. Detergent and rinse pump system:**

ProDose - accurate dosing with a peristaltic pump

**40. Energy Saving system:**

EnergySaving - Energy saving system due to lowering the boiler temperature

**41. Rinse system:**

UltraRinse2 - stainless steel rinsing arms including stainless steel nozzles with a geometry for spraying water in thin jets directly against the dishes, the rinsing pump ensures constant pressure

**42. Heating system:**

HotWash - System of simultaneous operation of the heating element of the bath and the boiler, reducing the time for starting the next cycle

**43. Quick heating system:**

QuickReady - System for rapid heating of water in the tank

**44. Hot water electric valve:**

Yes

**45. Closing door system:**

ProSoft - Reduces noise, dampens the door stop, which could cause damage to dishes

**46. Rack size [mm]:**

700 x 700

**47. Display type:**

LCD multifunction display

**48. USB port:**

Yes, for Firmware actualisation

**49. Drain pump:**

Yes

**50. Self-diagnostics:**

Yes

# Technical data sheet

Technical parameters



## Pot and pan washer double skin with drain pump 70x70 - 400 V

Model

SAP Code

00011973

### 51. Wash pump type:

two-way - DuoFlow

### 52. Detergent dispenser:

Yes

### 53. Rinse aid dispenser:

Yes

### 54. Water consumption of the washing cycle [l/basket]:

4

### 55. Rinse water temperature [°C]:

80-85

### 56. Additional information:

The product comes with 1x RM Clean+ 12 kg (00012271) and 1x RM Rinse+ 10 kg (00012273) for free

### 57. Program ProFessional 2:

Yes

### 58. Program ProFessional 4:

Yes

### 59. Program ProFessional 6:

Yes

### 60. Program ProFessional 8:

Yes

### 61. Program ProFessional 10:

Yes

### 62. Program ProClean:

Yes

### 63. Program ProDrain:

Yes

### 64. Program ProEco:

Yes

### 65. Program ProLong:

Yes

### 66. Program ProActive 5:

Yes

### 67. Program ProActive 7:

Yes